

COPYRIGHT
 THIS DOCUMENT AND ALL DATA CONTAINED HEREIN REMAIN THE PROPERTY OF O'DALY ARCHITECTS. IT IS SUPPLIED IN CONFIDENCE FOR EVALUATION PURPOSES ONLY UNDER THE CONDITION THAT SAME IS NOT USED, REPRODUCED OR TRANSMITTED IN ANY WAY TO OTHERS WITHOUT WRITTEN CONSENT.

DIMENSIONS
 UNLESS OTHERWISE STATED, DIMENSIONS SHOWN ARE IN MILLIMETRES. NO DIMENSIONS TO BE SCALED FROM THIS DRAWING. ALL DIMENSIONS TO BE CHECKED BY THE CONTRACTOR ON SITE AND ANY DISCREPANCIES TO BE REPORTED TO THE ARCHITECT.

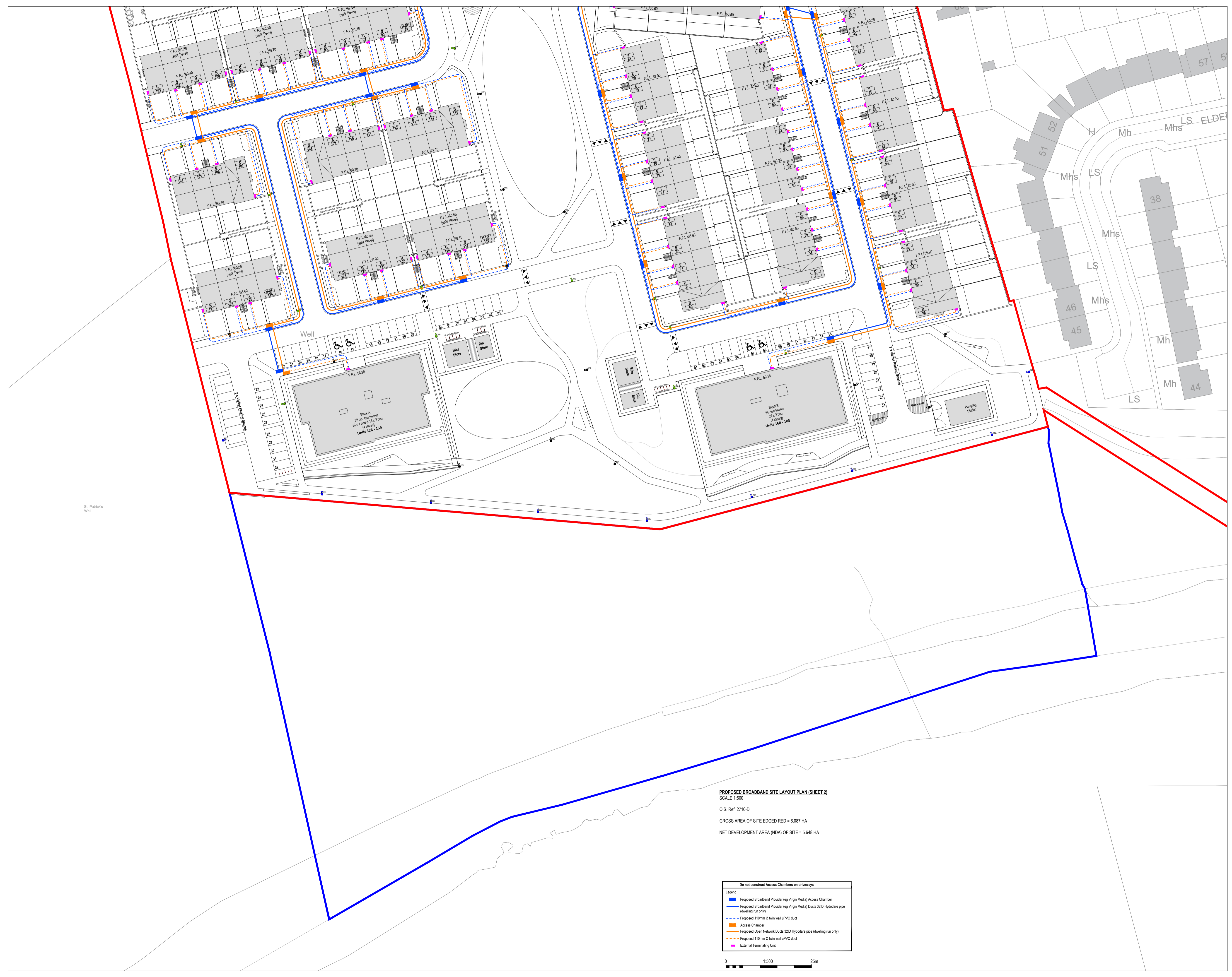
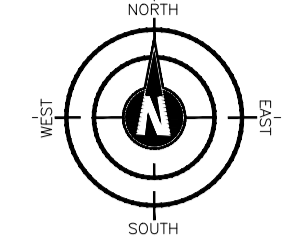

PROPOSED BROADBAND SITE LAYOUT PLAN (SHEET 2)
 SCALE 1:500
 O.S. Ref: 2710-D
 GROSS AREA OF SITE EDGED RED = 6.087 HA
 NET DEVELOPMENT AREA (NDA) OF SITE = 5.648 HA

- Do not construct Access Chambers on driveways**
- Legend**
- Proposed Broadband Provider (eg Virgin Media) Access Chamber
 - Proposed Broadband Provider (eg Virgin Media) Ducts 32ID Hydorads pipe (swelling run only)
 - Proposed 110mm Ø twin wall uPVC duct
 - Access Chamber
 - Proposed Open Network Ducts 32ID Hydorads pipe (swelling run only)
 - Proposed 110mm Ø twin wall uPVC duct
 - External Terminating Unit

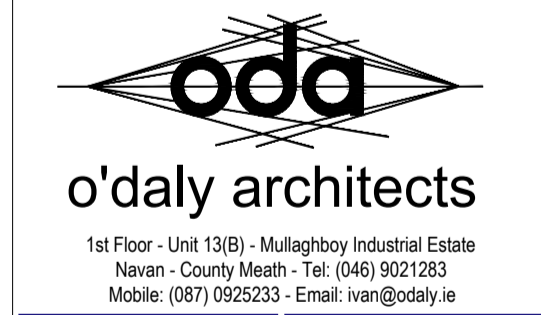
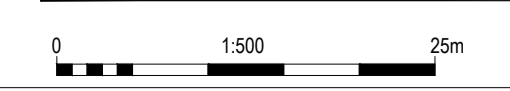

Client:
 Loughglyn Developments Ltd.

Project Name and Address:
 Proposed Large Residential Development (LRD) at "Crowpark 1st Division", Kildare Road, Trm, County Meath.

Project Stage:
 Planning

Drawing Name:
 Proposed Broadband Layout - Sheet 2

Drawn By: jod
Scale: 1:500 @ A1

Checked By: jod
Date: 04.06.2026

Drawing Number: 24004-AR-147
Revision: P01